

H (LOGIC 5.0) HOIST OPERATOR

Section 08 71 13



DATA SHEET

Key Features

STANDARD APPLICATION

Recommended for rolling steel doors/grilles and high or vertical-lift sectional overhead doors in standard duty-cycle commercial applications where a manual hoist is required

RATED DUTY CYCLE

Standard-duty: Up to 25 cycles/hour up to 90 cycles/day
(using continuous-rated motor)

OPERATOR SPEED

8-9 Inches per second

LIMIT SETTINGS

Mechanical

EMERGENCY DISCONNECT FOR MANUAL OPERATION

Floor-level emergency release sash chain

EMERGENCY DISCONNECT WITH AUTO-RECONNECT

Reconnects when tension is removed from emergency release sash chain

PROGRAMMING

Control function selector dial/tactile buttons

CIRCUIT BOARD

Solid-state Logic 5.0 circuit board

TIMER-TO-CLOSE

Programmable in 1 second and 15 second increments up to 68 minutes, standard

CLUTCH

Standard adjustable friction clutch

MID-STOP

Programmable

RUN TIME PROTECTION

Maximum run timer

MOTOR REVERSE ACTION PROTECTION

Delay-on-reverse circuit

MOTOR OPERATOR WALL CONTROL

3-Button Control Station with Maintenance Alert System (MAS)

Specifications

RADIO RECEIVER

LiftMaster® Security+ 2.0*

VOLTAGE CONNECTIONS

Single-phase: 115V/230V dual voltage; 3-phase: 208V/230V/460V dual voltage;

3-phase: 575V single voltage

CONTROL CIRCUIT

5VDC NEC class 2

DRIVE REDUCTION

Belt/chain & pulley; first-stage heavy-duty 5L V-belt; second-third-fourth stages

#48 chain; #50 output sprocket chain

BEARINGS/BUSHINGS

Industrial ball bearings on a 1" output shaft; heavy-duty oil-filled bushings on reduction shafts

BRAKE

Standard on 3/4 operators; optional on 1/2 HP

CONSTRUCTION

NEMA 1 type electrical box; heavy-duty 11-gauge steel frame with durable powder coat finish; all reduction sprockets drilled and pinned to shafts

WARRANTY

2 years

Installation Features

MAXIMUM DOOR WIDTH

22 feet standard with additional capability*

MAXIMUM DOOR HEIGHT

26 feet standard with additional capability*

MAXIMUM ALLOWABLE SQUARE FOOTAGE

640 square feet

INTERNET CONNECTIVITY

myQ® Technology enables remote monitoring and control of the commercial door via a smart phone, tablet, or computer**

* Contact us at Specs@LiftMaster.com for additional capabilities.

**LiftMaster Internet Gateway and myQ app required.

H (LOGIC 5.0) HOIST OPERATOR

Section 08 71 13

DATA SHEET



Dimensions

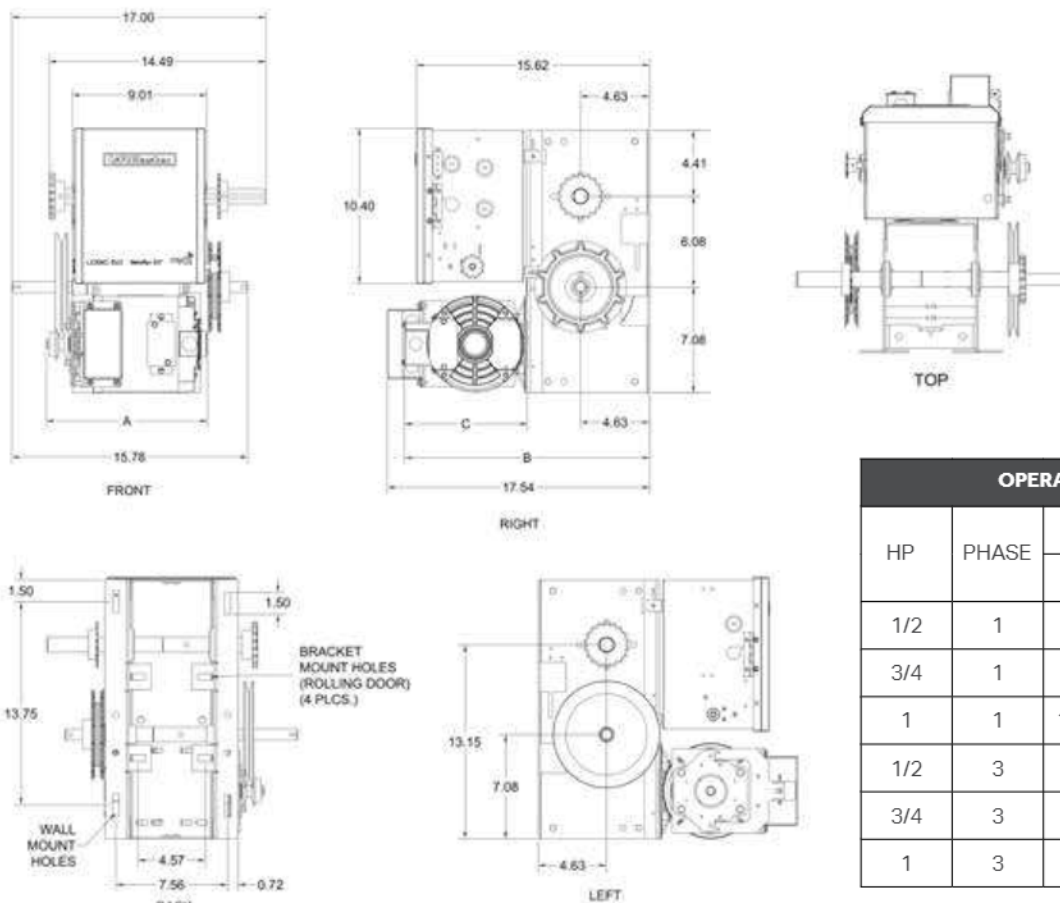

OPERATOR DIMENSION TABLE

| HP | PHASE | DIMENSIONS | | |
|-----|-------|------------|-----------|---------|
| | | A | B | C |
| 1/2 | 1 | 10-3/4" | 16-13/32" | 8-7/32" |
| 3/4 | 1 | 11-9/32" | 16-11/32" | 8-5/32" |
| 1 | 1 | 11-29/32" | 17-1/16" | 8-7/8" |
| 1/2 | 3 | 11-5/16" | 16-7/16" | 8-3/16" |
| 3/4 | 3 | 11-5/16" | 16-13/32" | 8-3/16" |
| 1 | 3 | 11-5/16" | 16-13/32" | 8-3/16" |

Notes:

1. Dimensions A,B & C may vary per motor manufacturer specification revisions and special modifications to the operator.

Capacity

| MAXIMUM DOOR AREA (SQ. FT.) | | | | | | |
|-----------------------------|------------------|---------------------|------------------------|---------------------|------------------------|------------------------|
| ROLLING | 24 ga. Steel | 22 ga. Steel | — | 20 ga. 18 ga. Steel | 16 ga. Steel | — |
| | Aluminum Grilles | Aluminum Doors | — | Steel Grilles | — | — |
| SECTIONAL | — | 24 ga. 22 ga. Steel | 20 ga. Steel | — | 16 ga. Steel | — |
| | Fiberglass | Aluminum Doors | Wood Doors | — | — | — |
| | — | — | 24 ga. Steel Insulated | — | 20 ga. Steel Insulated | 16 ga. Steel Insulated |
| HP | 1/3 | 310 | 285 | 260 | 210 | 175 |
| | 1/2 | 400 | 350 | 320 | 280 | 250 |
| | 3/4 | 560 | 500 | 450 | 380 | 325 |
| | 1 | 640 | 625 | 560 | 475 | 400 |

On steel insulated doors, a 24-gauge back panel is assumed. If a heavier back panel is supplied, use the next higher HP rating. Recommended max duty cycles: 25 per hour, up to 90 per day.