



# MultiBio 700

Multibiometric Access Control and Time & Attendance Reader

Modern, accurate and affordable...  
standalone fingerprint, facial and  
RFID readers



## MultiBiometric technology:

Identify or verify users by their face, fingerprint, proximity card or PIN/Password... or any combination, all conveniently from a single device. Built-in Infrared light source enables operation in dimly lit rooms.



## Communication:

MultiBio 700 installs easily on your network having both TCP/IP and RS232/485 serial ports. Its USB port allows for offline data backup and management when the network is unavailable.



## Display/Audio:

Stunning 3in color TFT touch screen provides ease of use and rich user experience with intuitive and user friendly GUI. Includes both voice and visual prompts which indicate the acceptance or rejection of fingerprint, face, ID card or PIN/Password.



## Capacity:

Supports one to many (1: N) matching for up to 400 faces and 5,000 templates or 20,000 cards/badges. Stores up to 100,000 transactions.



## Access control:

Contact Relays for door locks, exit button, alarms & bell. Supports 50 time zones, 99 groups and 10 unlock combinations. Wiegand IN and OUT ports can be used to connect MultiBio 700 to any ZK or 3rd party access control panels and peripherals.



## Options:

MultiBio 700 can be configured with optional internal modules which read HID Prox, HID iclass or 13.56 MHz Mifare cards.



## For Software Developers:

Free SDK and development tools are available for developers/partners who wish to integrate MultiBio 700 with any application which requires verifying people. Custom development is also available for OEM partners upon request.

## Standalone Installation

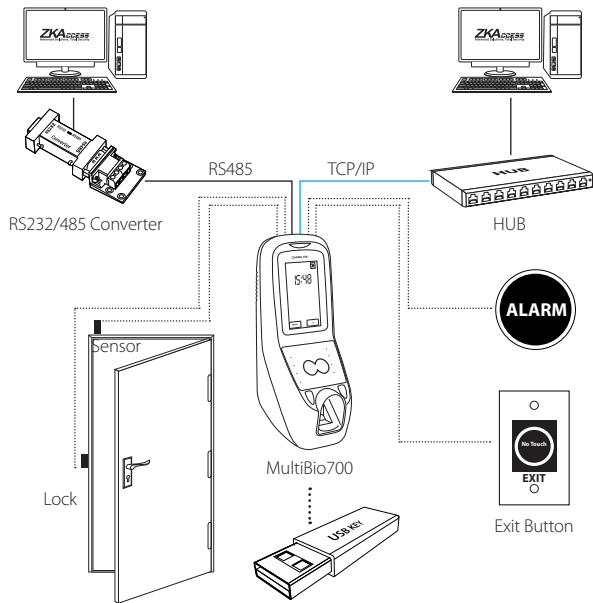

## Installation with Access Control Panel

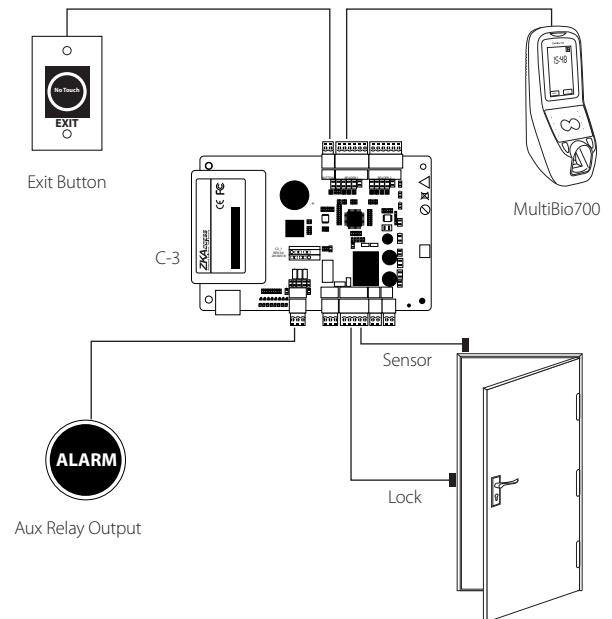

## Specifications

### Capacity

**Face:** 400 (expandable to 3,000)  
**Fingerprint:** 2000 (expandable to 5,000)  
**Card:** 10000 (optional)

### Display

3 in. TFT Touch Screen Display

### Camera and Light Source

640 x 480 pixel camera  
 Highly efficient Infra Red Light Source

### Communication

Ethernet, RS 232, RS485, Weigand Input and Output,  
 USB Host

### Power

12V DC, 3A

### Environment

Operating Temperature:  
 32° to 113° F ( 0° to 45° C)  
 Operating Humidity: 20% to 80%

### Dimensions

**Length:** 7.7 in (19cm),  
**Width:** 3.9 in (10cm),  
**Height:** 10.8 in (27cm)  
**Weight:** 3lbs (1.36kg)

### Supported Card Formats

ID Card  
 HID Card  
 Mifare Card

## Part Numbers

MultiBio 700

Multi iBio 700-ID with Proximity card reader

MultiBio700-HID with HID card reader

MultiBio 700-M with Mifare card reader

## What's in the Box

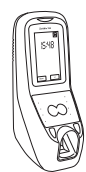

MultiBio700



Installation Template

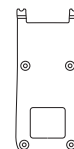

Back Plate



Measuring Tape

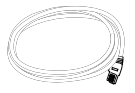

Network Cable

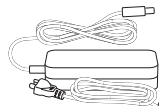

AC Power Adapter



Cables

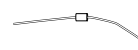

Diode



Screws



Screwdriver



Design and Specifications subject to change without notice

6 Kingsbridge Road, Suite 8  
 Fairfield, NJ 07004

+1 862 505 2101

sales@zkaccess.com

zkaccess.com