

ASO SENTIR EDGE

Our packages include the UL Recognized Sentir model edge you have grown to know and love but with a twist. Each edge kit comes with 8.2K, 10K and Normally Open (non-monitored) termination resistors to enable it to work with a variety of operator manufacturers to meet UL325 standards, plus non-monitored applications. No more guessing what edge variation to carry on the truck.

This edge should only be used with operator manufacturers calling out the ASO Sentir model edge as a tested and compatible entrapment device for their ecosystem. Available in 4ft, 5ft, and 6ft lengths or build your own (comes in 82' rolls).

The One Edge Solution!

An
Industry
First!



Kit includes: contact edge, aluminum channel, and all components to assemble a complete edge.



Included Termination Plugs



Available Lengths

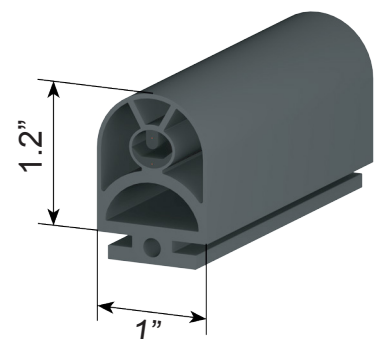
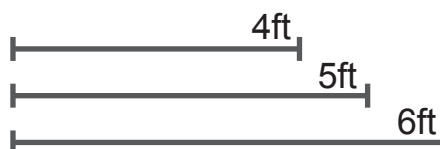

Available at a CPSG branch near you or buy [online](#).

ASK
The Access
Experts!

National Sales 877-531-6122
Technical Support 877-531-6123
ControlledProducts.com

Stay connected at MyCPSG.com
[EVENTS](#) [PRODUCTS](#) [SUPPORT](#) [CAREERS](#)



Assembly Instructions

Each edge kit comes with 8.2K, 10K and Normally Open (non-monitored) termination resistors to enable it to work with a variety of operator manufacturers to meet UL325 standards, plus non-monitored applications.

This edge should only be used with operator manufacturers calling out the ASO Sentir model edge as a tested and compatible entrapment device for their ecosystem. Available in 4ft, 5ft, and 6ft lengths or build your own (comes in 82' rolls).

Safety contact edges may only be assembled and installed by authorized personnel!

ASO GmbH excludes all liability for damage caused of an incorrect assembly and installation of the contact edges!

THIS STEP IS ONLY NECESSARY IF TRIMMING IS REQUIRED

Cutting the safety-contact-edge

The safety-contact-edge is cut 1 inch shorter than the final length dimension to allow for the length of the end caps on each end. The aluminum channel should be cut to the final length dimension. Make sure that the cut surfaces are rectangular and clean, so the cut should be made starting at the chamber side of the safety edge. The scissors or table lever blade offered by ASO should be used for this purpose.

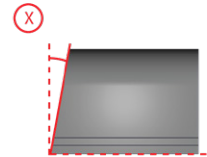
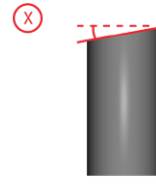
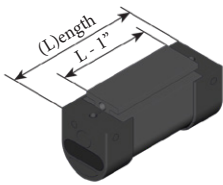

1) Preparing end caps

A) Water drain plugs - It is necessary to remove water drain plugs. For vertical mounting, remove the two marked areas in the lower end cap, for horizontal mounting, remove the two marked areas in both end caps.

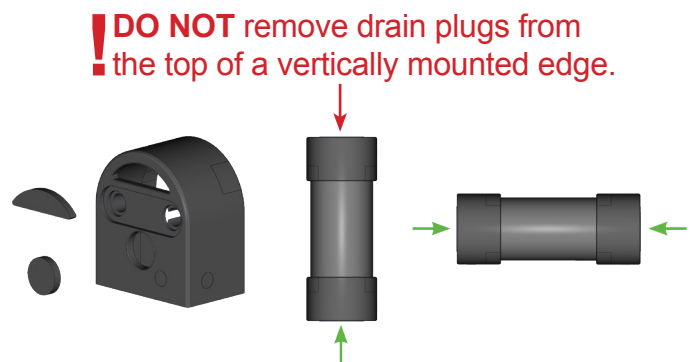

B) Connection cable - Choose desired cable exit of end cap. If necessary, stitch through the marks.

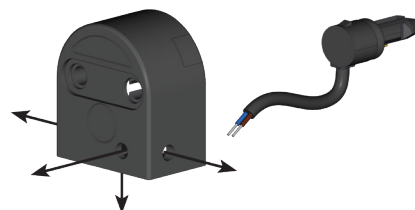

Assembly Instructions

2) Insert lock cap

Press the clamp straight into the hollow chambers around the internal switching chamber until it is tightly against the surface of the profile. Then check whether the outer wall of the switching chamber abuts the clamp. Slight rotational movements of the clamp can cause misalignment.

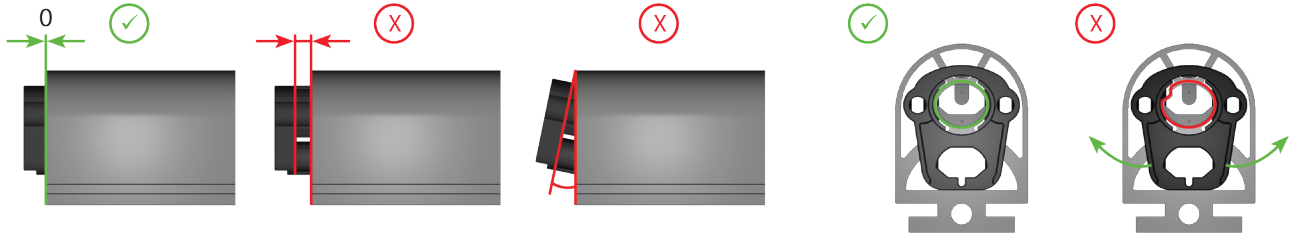
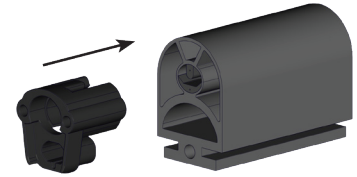

3) Insert the contact plugs

(Wired plug at one end and termination plug at the other.)

Choose the termination plug that fits your application (8.2K, 10K, or NO). For the required sealing, press both the termination plug and wired plug straight and firmly into the switching chambers on each end. The stop point on the plug should be as close as possible to the end face of the clamp. Then press the plug a second time to ensure a proper fit.

Termination Plugs

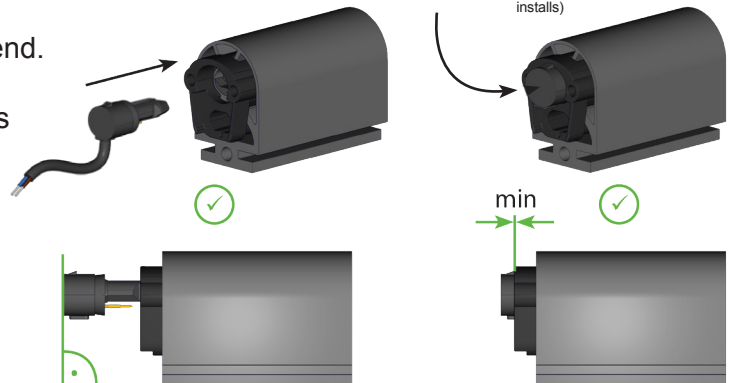

4) Put on end caps

Push the end cap onto the safety edge and fix it with the clip until it rests in the predetermined position of the end cap and noticeably locks in the clamp. Then press the fixation clip a second time.

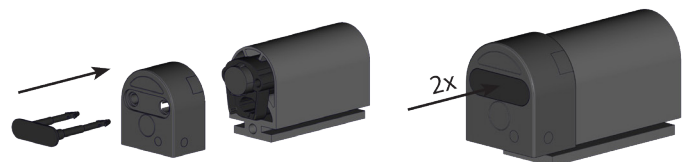

5) Electrical testing of the safety contact edge

Measure the contact edge with a multimeter. In rest position, the resistance value has to be 8.2k Ω , or 10k Ω \pm 500 Ω . When edge is activated, the resistance should not exceed 500 Ω .

